

# SENTRY Modular Coalescing Filters

# FCD10 Models Port Sizes: 1/8, 1/4; Tube Fittings



Model Shown: FCD10-2

## SPECIFICATIONS

### Ambient/Media Temperature:

40° to 125°F (4° to 52°C).

### Body:

Acetal.  
Bowl: 2-Ounce (60-ml) capacity polycarbonate plastic; optional aluminum bowl.

### Bowl Drain:

Internal automatic drain; optional manual drain.

**Filter Element:** 0.3- $\mu$ m-rated borosilicate-glass-fiber coalescing element; optional 0.01- $\mu$ m-rated element.

**Fluid Media:** Compressed air.

### Inlet Pressure:

15 psig (1 bar) minimum with automatic drain.  
150 psig (10 bar) maximum.

**Seals:** Nitrile.

**APPLICATION NOTE:** A general purpose filter must be installed ahead of a coalescing filter to ensure good performance and to extend the life of the coalescing element.

- ◆ Modular assembly and mounting.
- ◆ Threaded ports or quick-connect fittings for tubing up to 10 mm in diameter.
- ◆ 0.3- $\mu$ m-rated coalescing filter element; optional 0.01- $\mu$ m-rated element.
- ◆ High-strength polycarbonate plastic filter bowl; optional aluminum bowl.
- ◆ Internal automatic drain; optional manual drain.
- ◆ NPTF port threads; optional BSPP threads.

## FLOW CHARTS

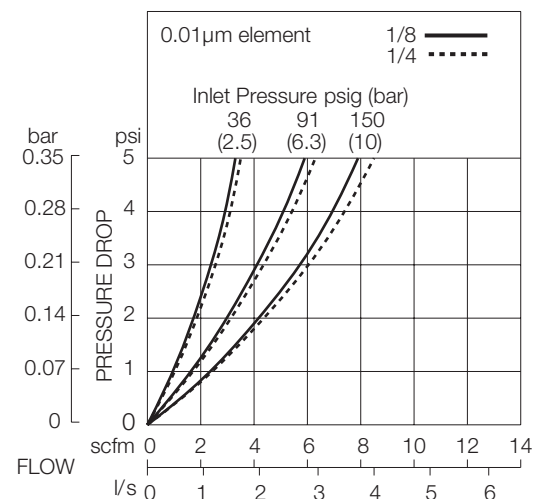
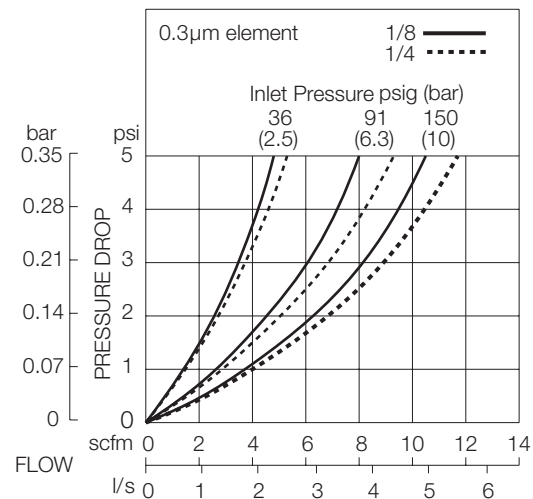

## DIMENSIONS inches (mm)

| Ports   | A        | B †      | C        | Depth    | Weight<br>lb (kg) |
|---|----------|----------|----------|----------|-------------------|
| No Port   | 1.7 (43) | 3.6 (92) | 0.5 (13) | 1.8 (45) | 0.27 (0.12)       |
| 1/8, 1/4  | 3.0 (76) | 3.6 (92) | 0.5 (13) | 1.8 (45) | 0.49 (0.22)       |
| <b>Models below have quick-connect fittings for tubing.</b> |          |          |          |          |                   |
| 1/4   | 3.4 (86) | 3.6 (92) | 0.5 (13) | 1.8 (45) | 0.47 (0.21)       |
| 3/8   | 3.9 (99) | 3.6 (92) | 0.5 (13) | 1.8 (45) | 0.47 (0.21)       |
| 4 mm  | 3.4 (86) | 3.6 (92) | 0.5 (13) | 1.8 (45) | 0.47 (0.21)       |
| 6 mm  | 3.4 (86) | 3.6 (92) | 0.5 (13) | 1.8 (45) | 0.47 (0.21)       |
| 8 mm  | 3.1 (79) | 3.6 (92) | 0.5 (13) | 1.8 (45) | 0.47 (0.21)       |
| 10 mm   | 3.9 (99) | 3.6 (92) | 0.5 (13) | 1.8 (45) | 0.47 (0.21)       |

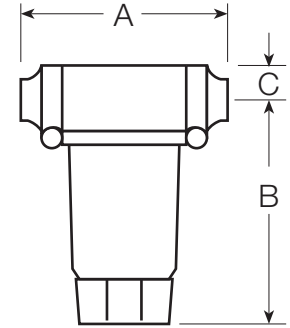

† Dimension for plastic bowl; metal bowl is 4.3 (109).

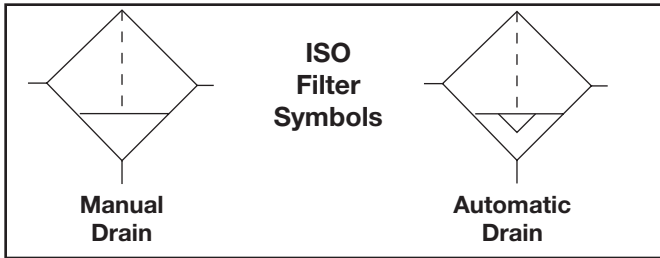

## REPLACEMENT FILTER ELEMENT KITS

| Element Rating                            | Kit Number |
|---|------------|
| 0.3 µm (Std element).....                 | KA10F-09   |
| 0.01 µm<br>For models with E8 option..... | KA10F-09E8 |

## ORDERING INFORMATION

Change the letters in the sample model number below to specify the filter you want.

**B FCD 10 P - 2 X Y W**

### BOWL TYPE

Plastic bowl..... Leave blank  
Metal bowl..... B

### BOWL DRAIN

Internal automatic drain ..... FCD  
Manual drain..... FC

### MOUNTING HOLE LOCATION

Bottom mount (Standard) ..... Leave Blank  
Top mount ..... P

### INLET PORT SIZE

No inlet and outlet ports.. .Leave blank

#### Threaded:

1/8 NPTF ..... 1  
1/4 NPTF ..... 2

#### Fittings for Tubing:

1/4 ..... 04  
3/8 ..... 06  
4 mm ..... M4  
6 mm ..... M6  
8 mm ..... M8  
10 mm ..... M10

### PORT TYPE

As specified in **INLET PORT**... Leave Blank  
BSP threads on both ports..... W

### OPTIONS:

None..... Leave Blank  
0.01-µm-rated coalescing .....E8 element

### OUTLET PORT SIZE

Same as inlet port .....Leave Blank

#### Threaded:

1/8 NPTF ..... 1  
1/4 NPTF ..... 2

#### Fittings for Tubing:

1/4 ..... 04  
3/8 ..... 06  
4 mm ..... M4  
6 mm ..... M6  
8 mm ..... M8  
10 mm ..... M10

**Coalescing  
FILTERS**